

20VA Plug-in Transformer

Safety insulating transformer



HLP 212.20
HLP 224.20



Primary : Europlug, 230V 50/60Hz
Secondary : DIN-socket, ~11,5V or ~24V
Protection : IP20
Built-in thermal protector
Colour : Black or white

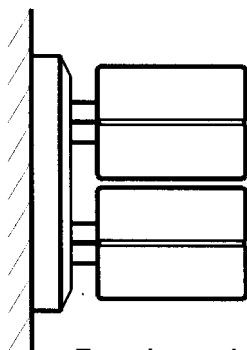
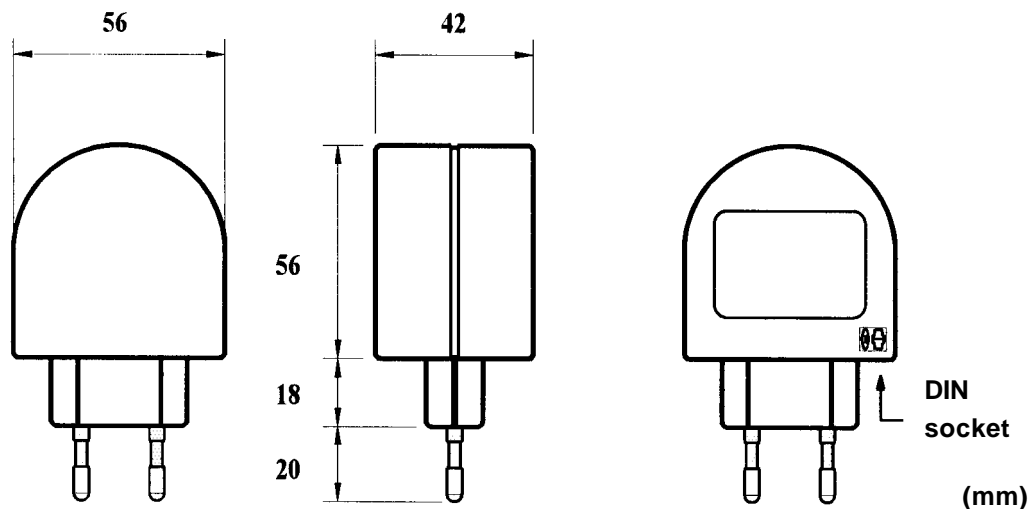

Two pieces plug-in transformers
mounted in a common double wall-socket.

Weight : 360g
Volume : 105cm³
No load loss : appr. 0,34W
Temp.rise : max 50°C

No guarantee for accuracy of data.
Technical changes reserved. Ed. 6/04

20VA Plug-in Transformer

Safety insulating transformer

Class 2 Power Unit



HLP 11220

Primary : US-plug, 120V 60Hz
Secondary : DIN-socket, ~11,5V
Protection : IP20
Built-in thermal protector
Colour : Black or white

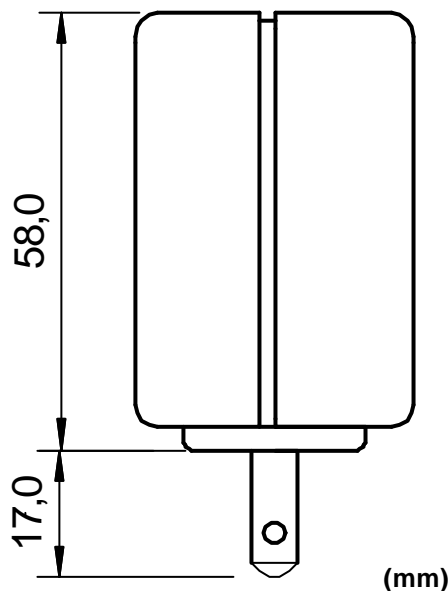
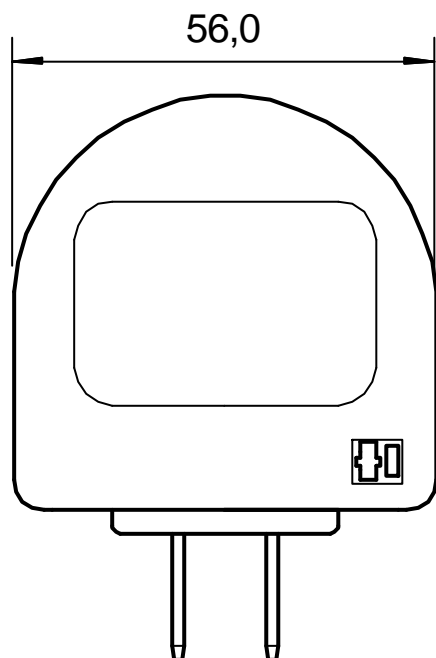
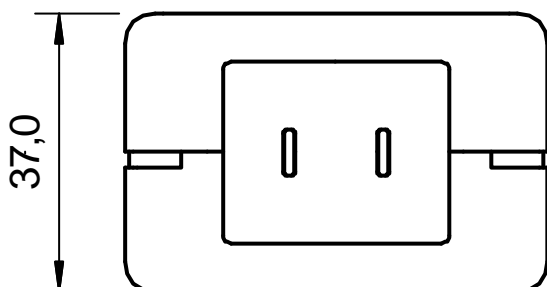

Weight : 330g

No load loss : appr. 0,25W

Temp.rise : max 55°C

No guarantee for accuracy of data.
Technical changes reserved. Ed. 2/01

20VA Plug-in Transformer

Safety insulating transformer



HLP 41220

Primary : UK-plug, 230/240V 50/60Hz

Secondary : DIN-socket, ~11,8V

Protection : IP20

Built-in thermal protector

Colour : Black or white

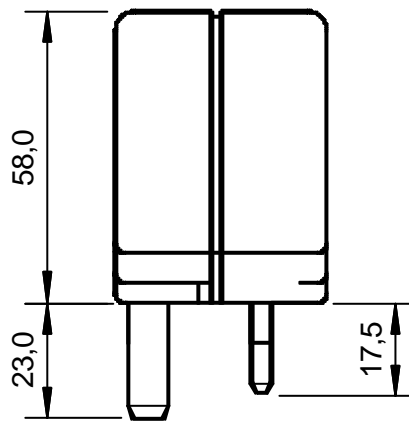
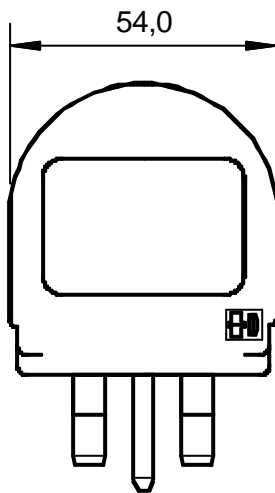
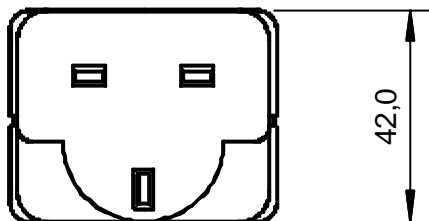

(mm)

Weight : 370g

No load current : max 10mA

Temp.rise : max 50°C

No guarantee for accuracy of data.
Technical changes reserved. Ed. 3/04

Postal address
Box 3
SE-351 03 Växjö
Sweden

Visiting address
Södra Vallviksvägen 6
SE-352 51 Växjö
Sweden

Toroid International AB
www.toroid.se
E-mail: toroid@toroid.se

Phone
Int: +46 470 755400
Nat: 0470 755400

Fax
Int: +46 470 755419
Nat: 0470 755419

50VA Plug-in transformer

TOROID's range of safety isolating transformers are of a wall plug-in design based on toroidal transformers. The transformers are approved by following safety authorities.



The transformers meets class II requirements (double insulated) according to EN 61558-1 and withstands 4000Vac for one minute.

Data :	Primary:	Europlug, 230V 50/60Hz
	Secondary:	DIN-socket, ~9,5-42V 50VA
	Protection:	IP20
	No load loss:	Approx. 0,4W
	Weighth:	600g (1½ Lbs)
	Colour:	Black or white
	Built-in temperature limiting fuse	

Approved for secondary full-load voltages from 9,5V to 42V.

Standard secondary voltages:

11,5V.....	P/N	HLP212.50
18V.....	P/N	HLP218.50
24V.....	P/N	HLP224.50
42V.....	P/N	HLP242.50

Dimensions (mm) :

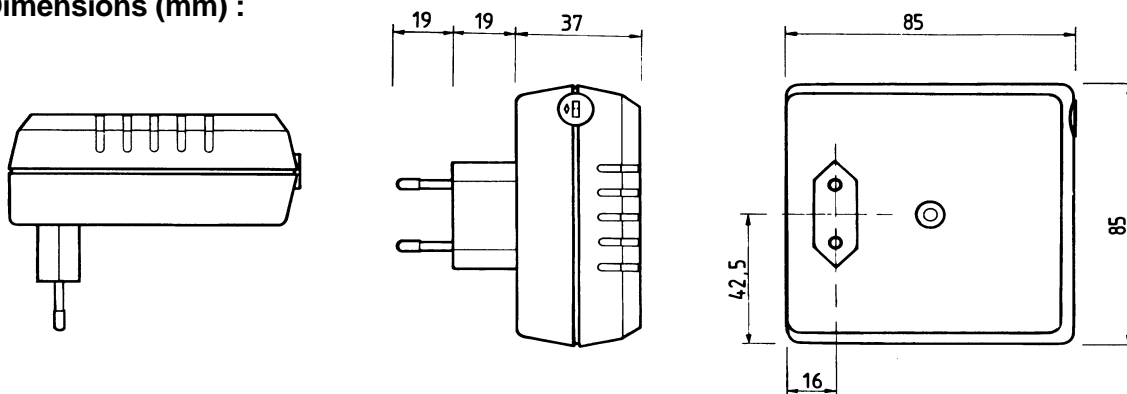

Accessories : 2,5 meter secondary cable (2x0,75mm²), black or white, with moulded DIN-socket.

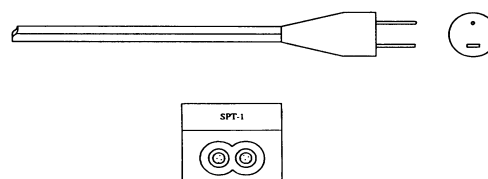

No guarantee for accuracy of data.
Technical changes reserved. Ed.5/04