

Valeo

beep&park

PARKING ASSISTANCE System
Système d'AIDE AU STATIONNEMENT
Sensore di PARCHEGGIO
Sistema de AYUDA PARA ESTACIONAMIENTO
Sistema de AUXÍLIO DE ESTACIONAMENTO
EINPARKHILFE-System

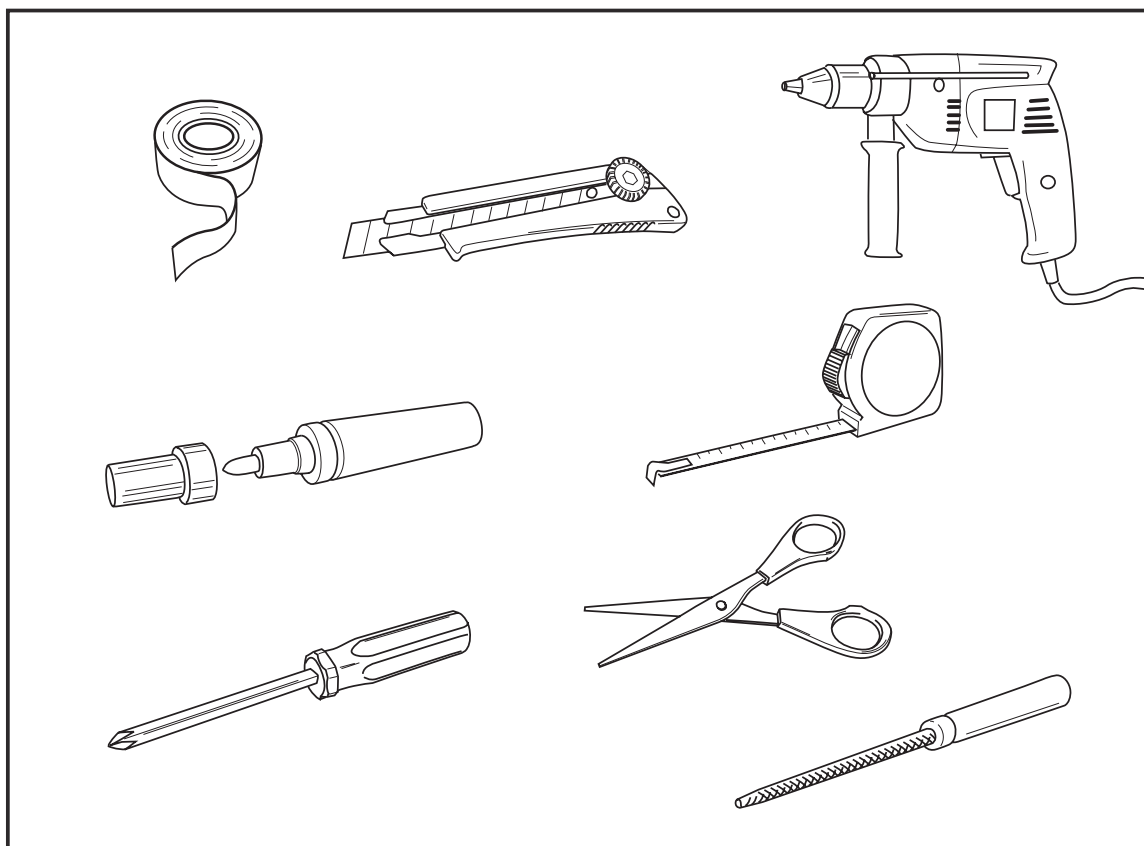
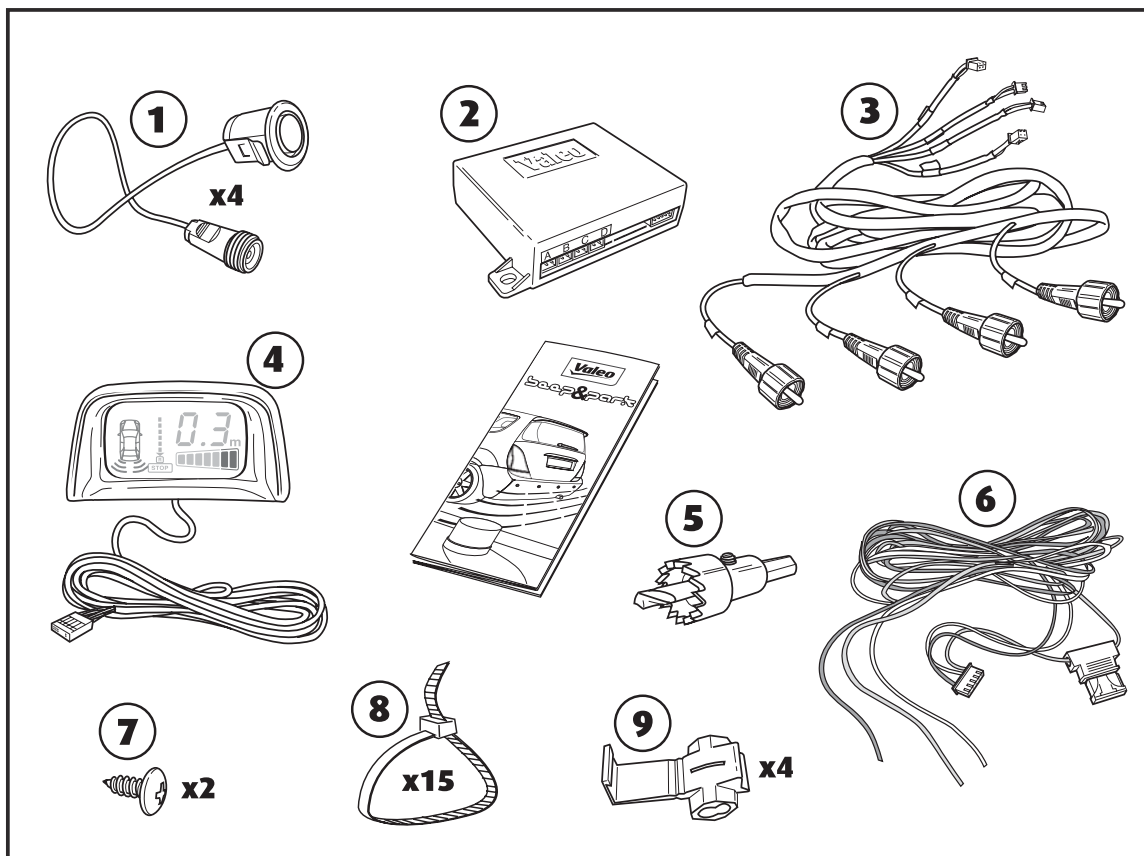

632002



OK

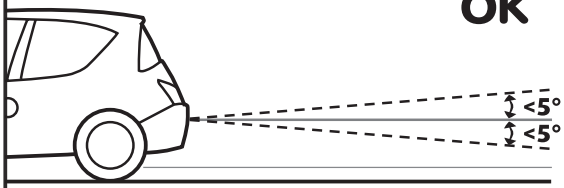
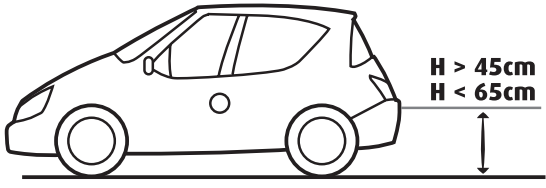

OK

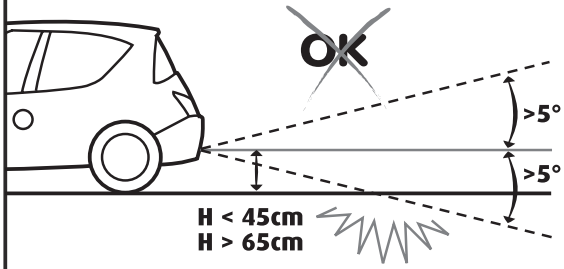

OK

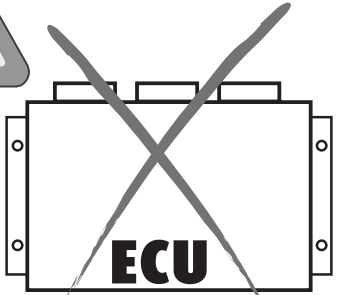

No Reset Necessary
Réinitialisation non nécessaire

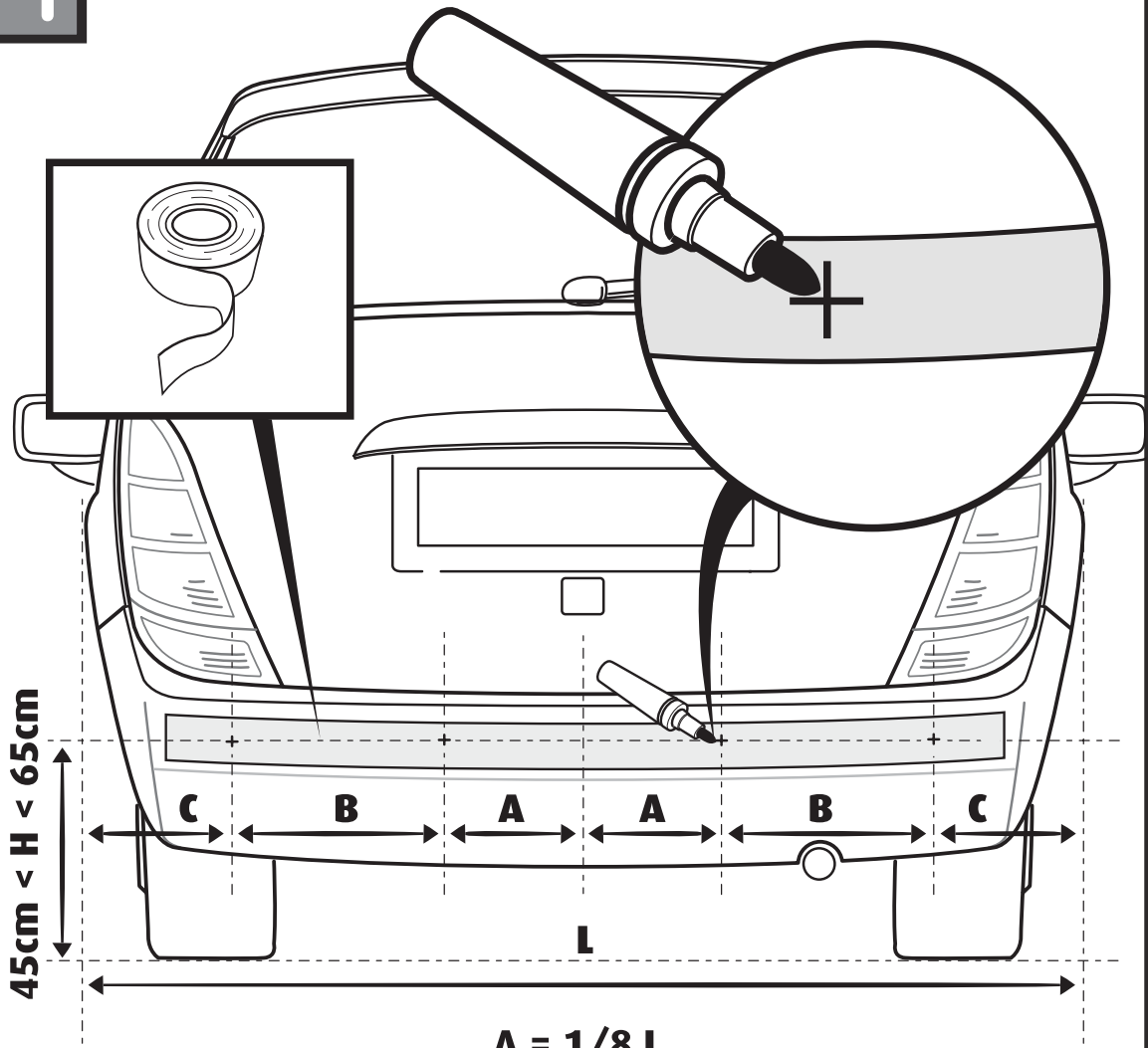
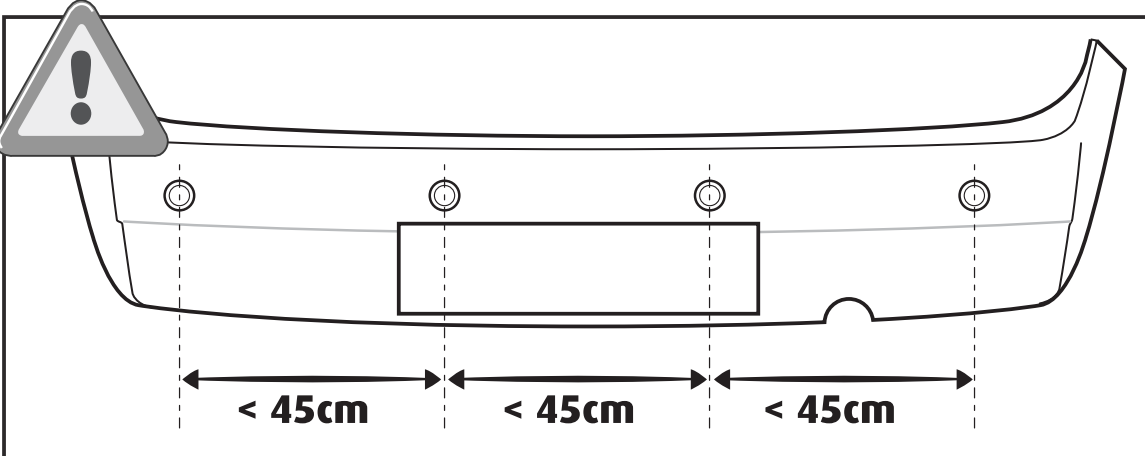

$A = 1/8 L$
 $B = 2/8 L$
 $C = 1/8 L$

2

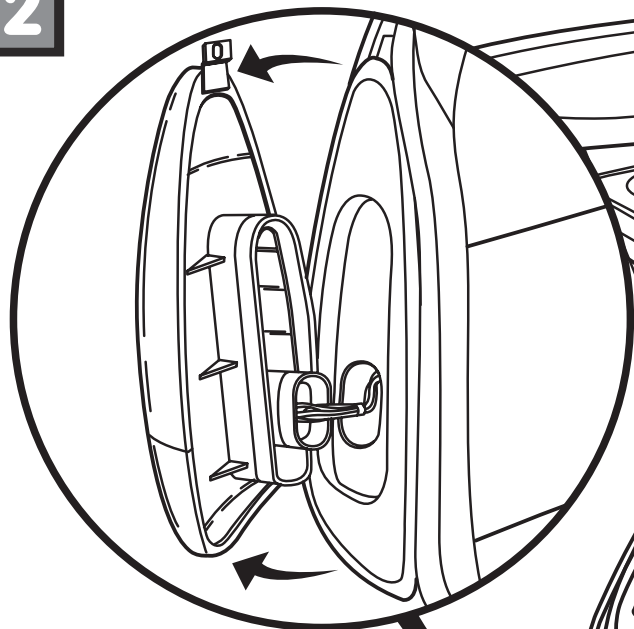

2

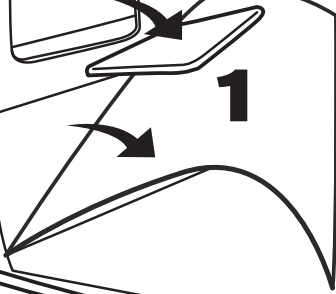

1

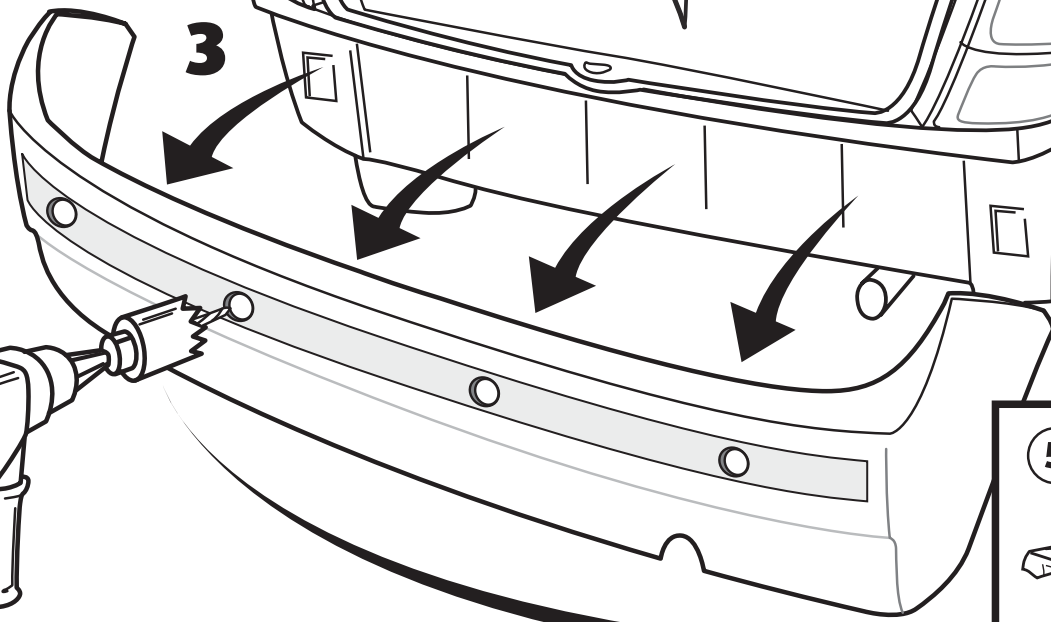

3

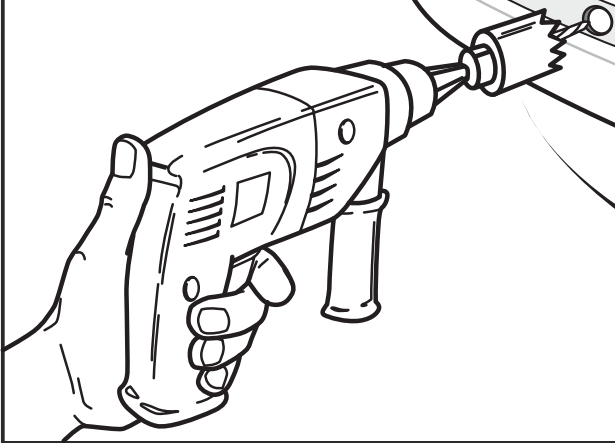

5

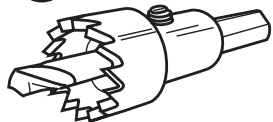

Ø = 18,5mm

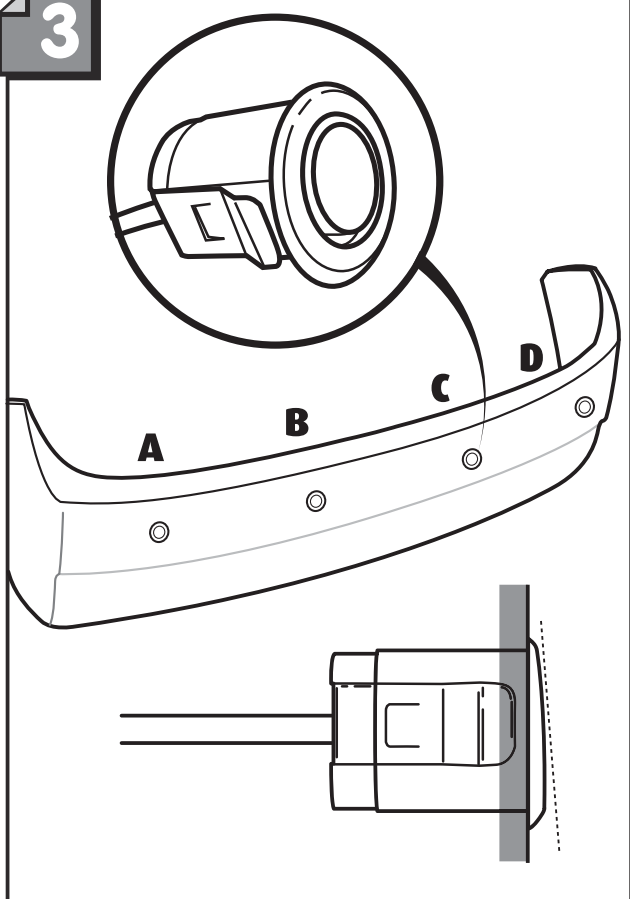
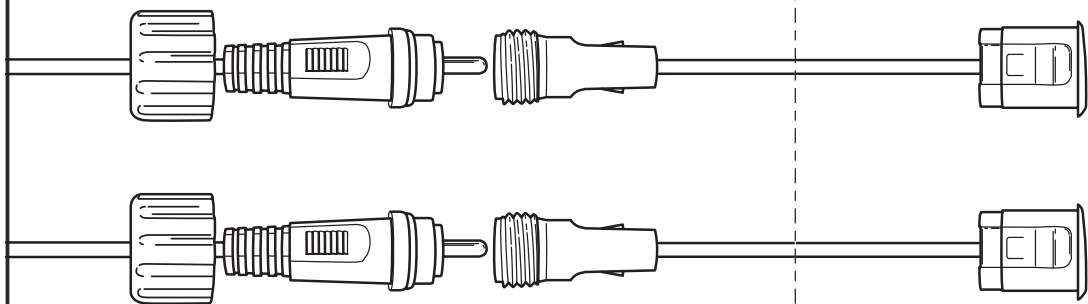
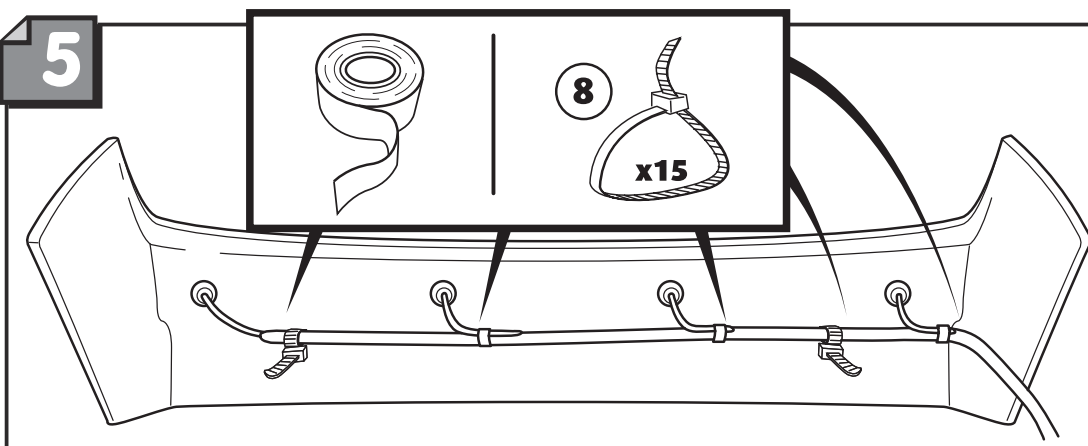
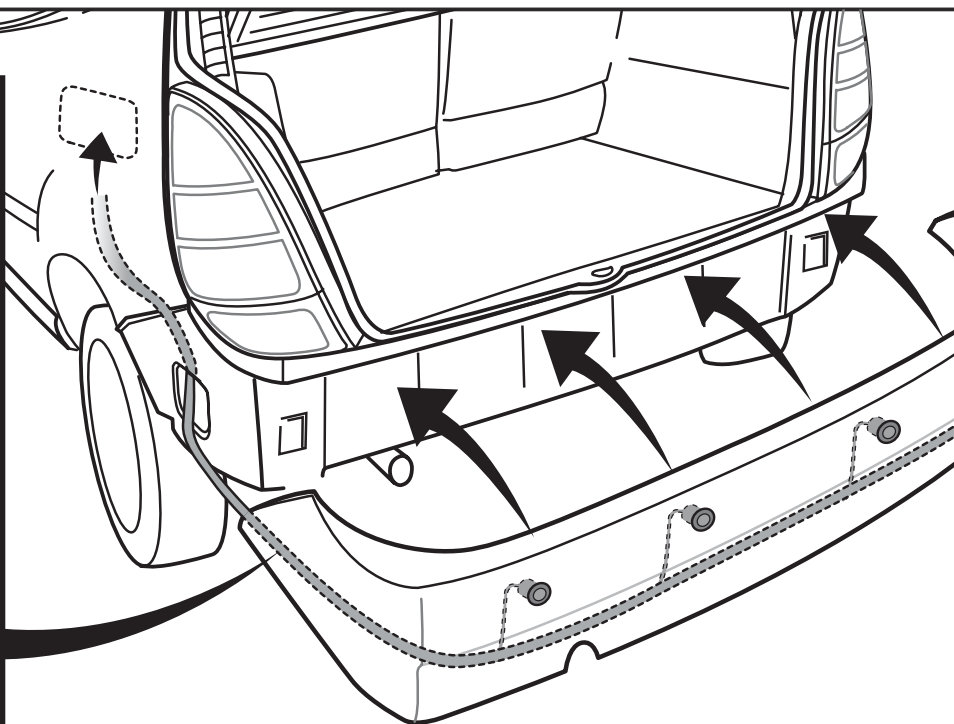
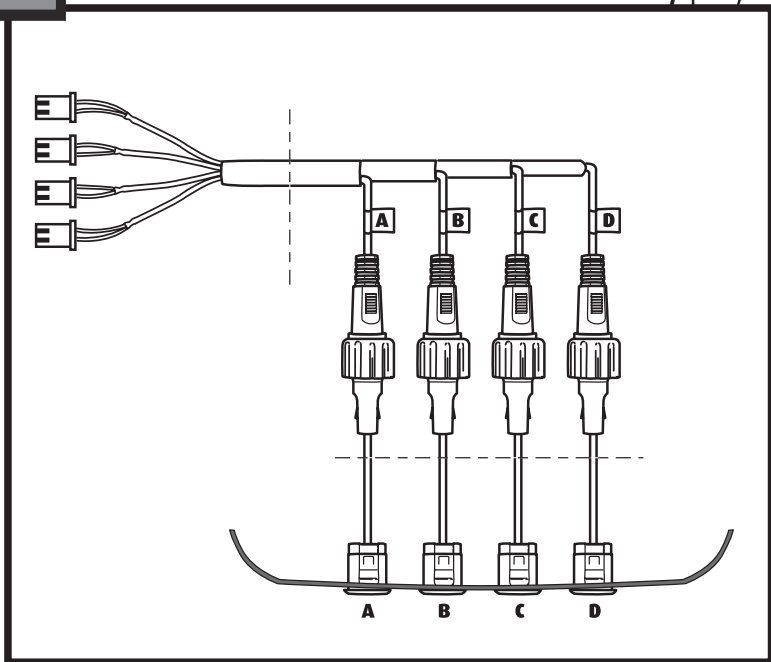
3**4****5****6**

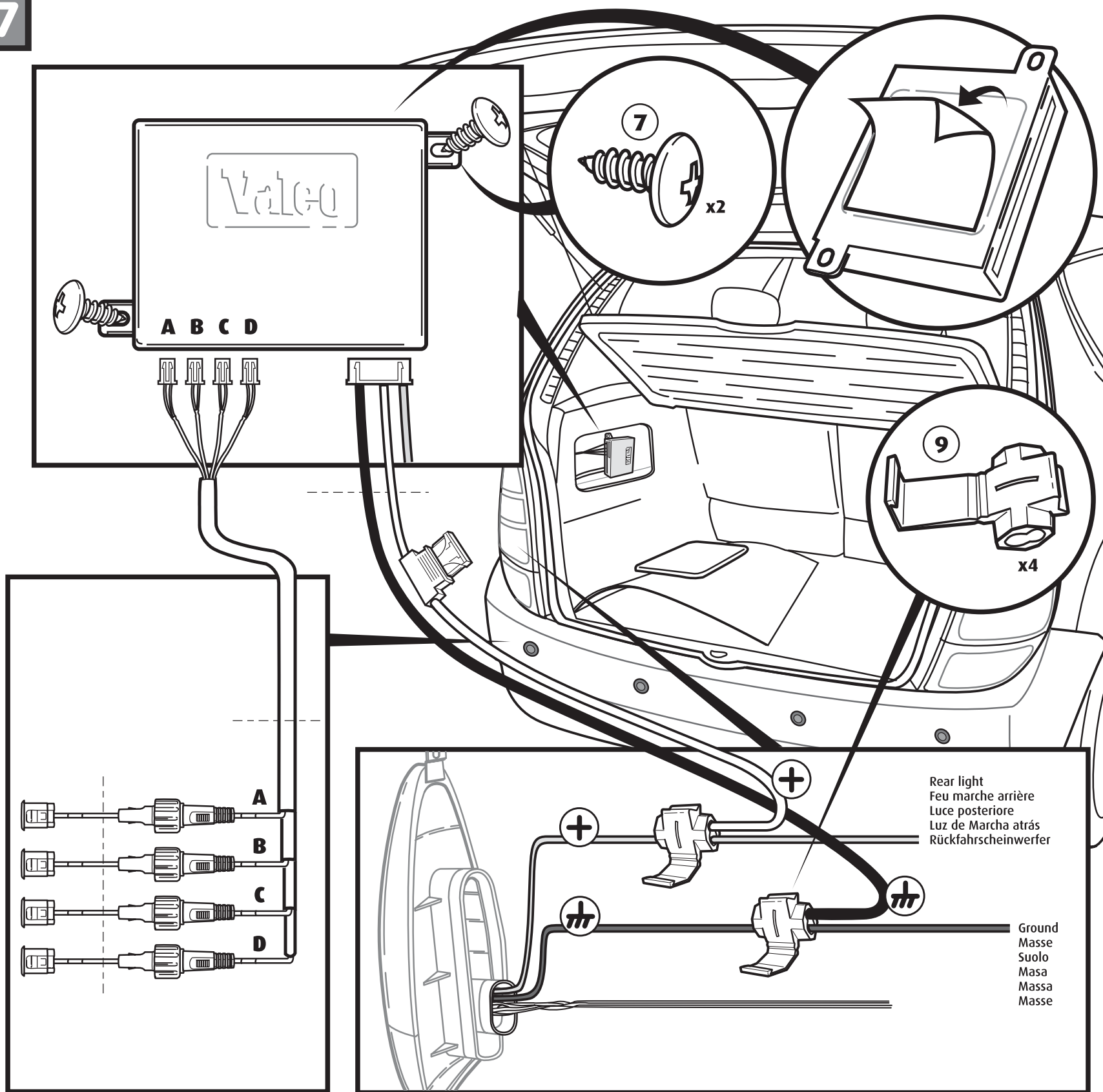

8

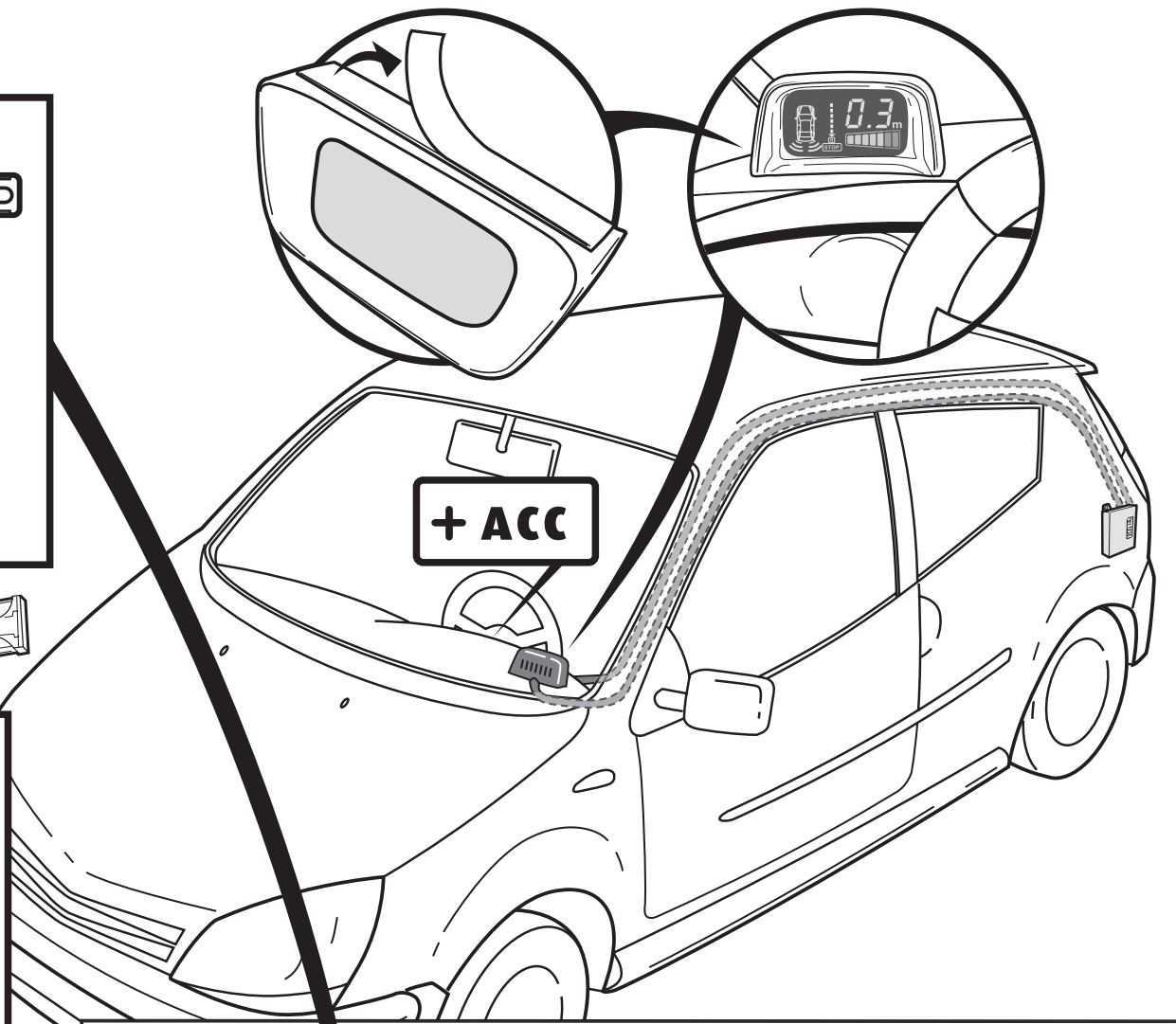
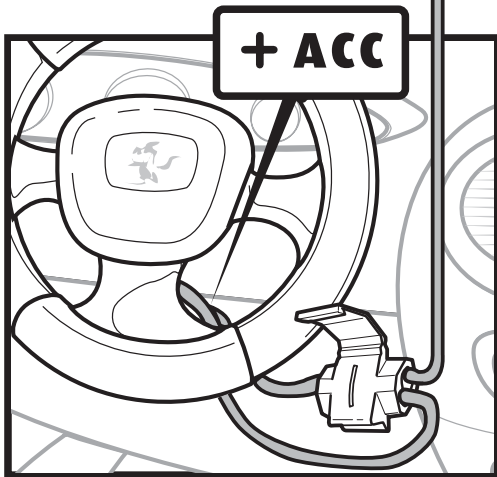
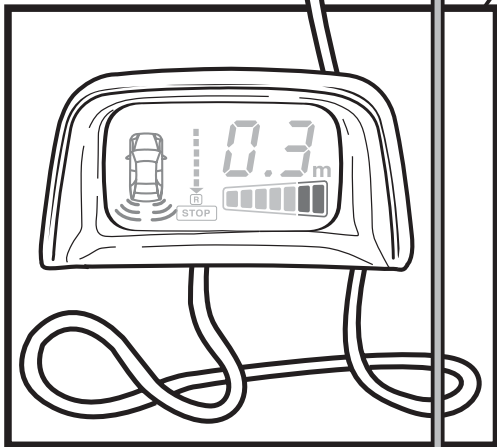
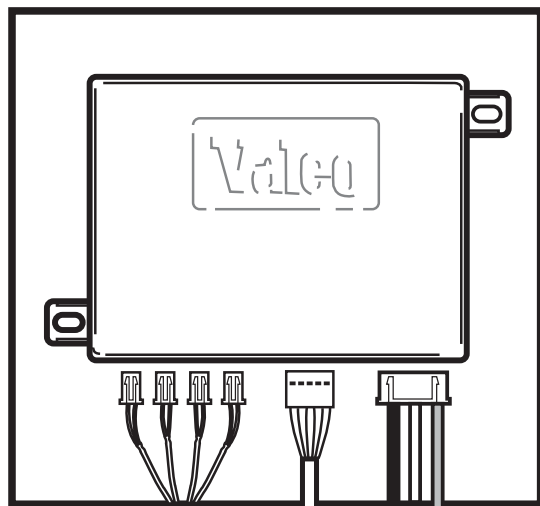

9

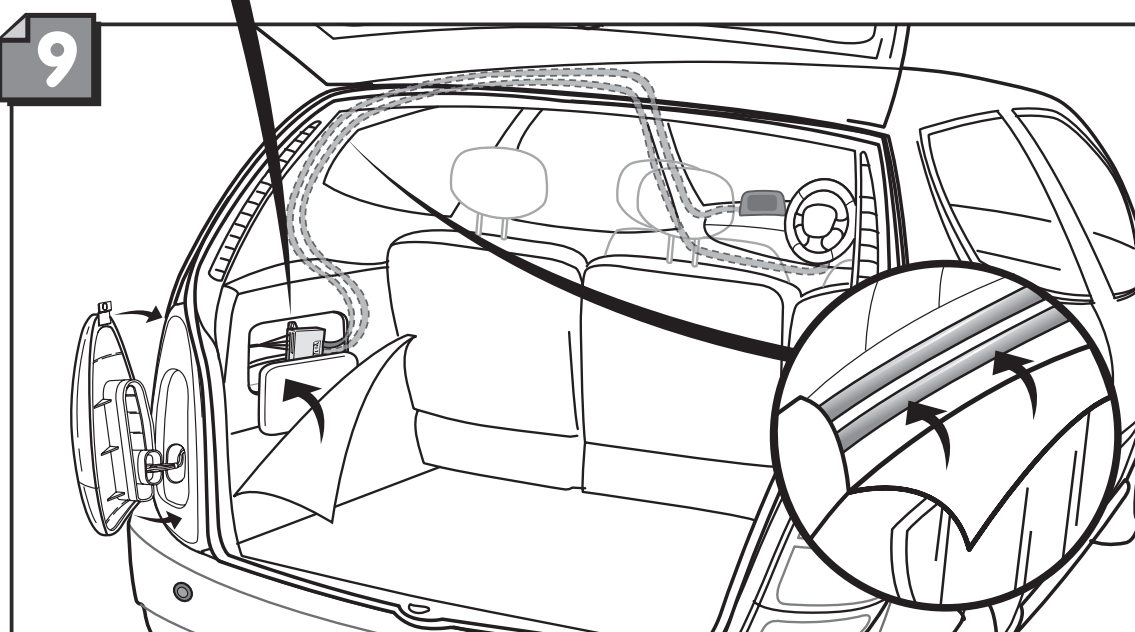

10

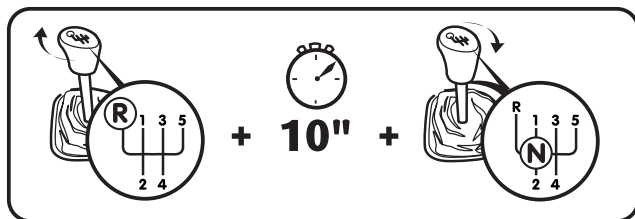
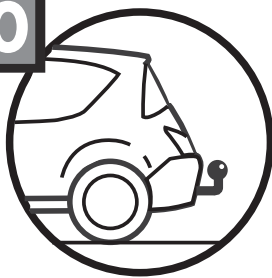

x5

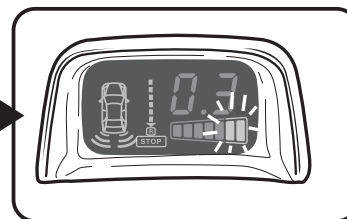

x3

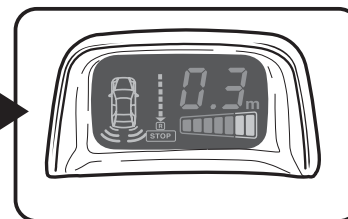

8"

Harness
Faisceau électrique
Cavi di collegamento
Cableado
Cablagem
Kabel

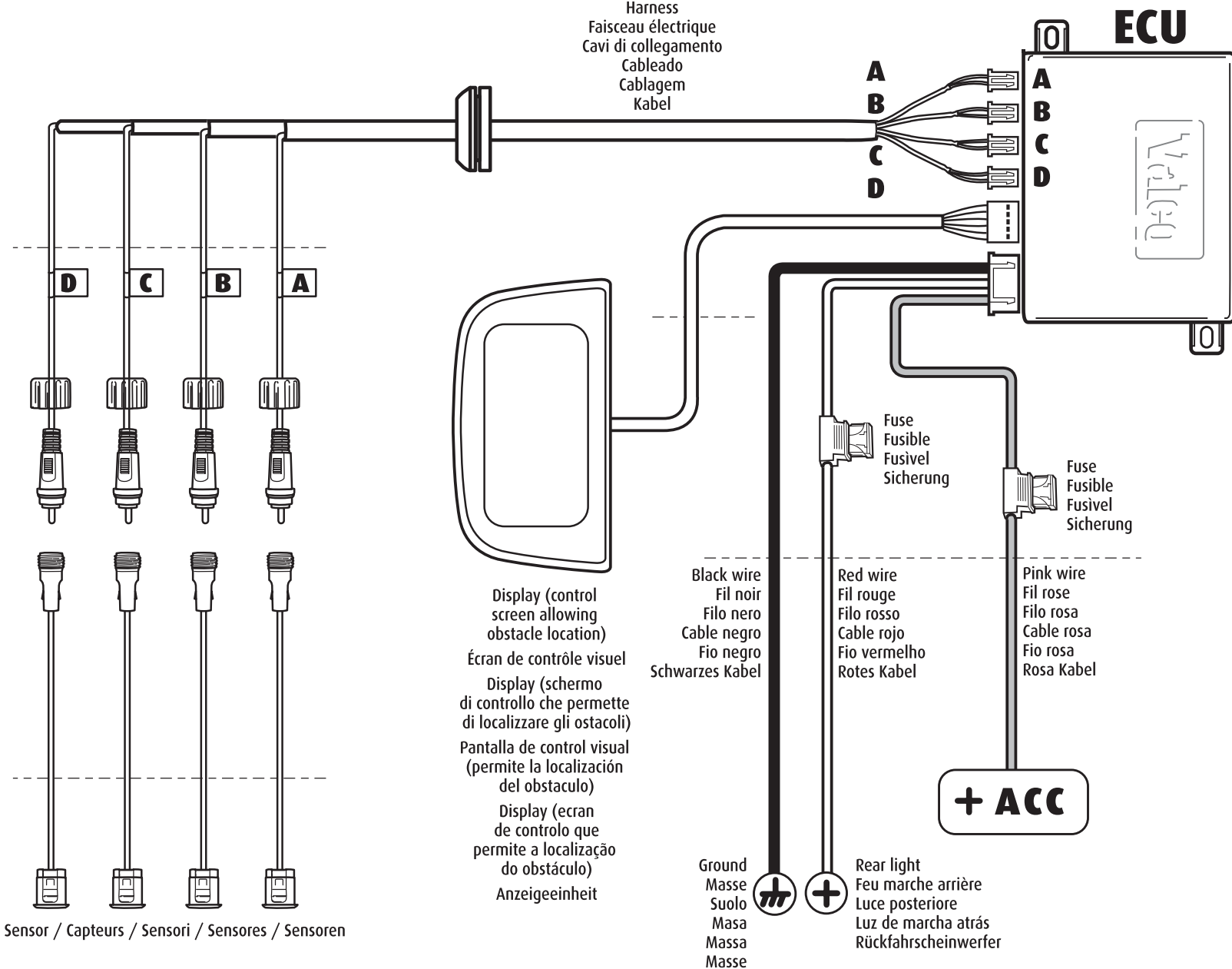

Symptom/Diagnosis • Symptôme/Diagnostic
 Sintomo/Diagnosi • Sintoma/Diagnosis
 Sintoma/Diagnóstico • Symptom/Diagnose



- ▶ If the buzzer makes a Beep Beep Beep noise without any obstacles, then it means that one or several sensors have been improperly fitted or damaged.
- ▶ E1 means one sensor is not working properly, E2: 2 sensors, E3: 3 sensors, E4: 4 sensors. Screen flashing allows defect sensor identification.
- ▶ Check sensors are properly fitted.
- ▶ In case of crash, you can replace the concerned sensor by one available in the Valeo spare parts offer.



- ▶ Si, en l'absence d'obstacle, le buzzer émet un son Beep Beep Beep, cela signifie qu'un ou plusieurs capteurs ont été mal connectés ou endommagés.
- ▶ E1 signifie qu'un capteur ne fonctionne pas normalement, E2 : 2 capteurs, E3 : 3 capteurs, E4 : 4 capteurs. Le clignotement de l'écran permet d'identifier le capteur concerné.
- ▶ Vérifiez que les capteurs sont correctement montés.
- ▶ En cas de choc, remplacez le capteur défectueux par un capteur disponible dans l'offre Valeo en pièces détachées.



- ▶ Se il segnalatore acustico emette Beep Beep Beep senza alcun ostacolo in prossimità del veicolo, significa che uno o più sensori non sono stati montati correttamente oppure sono danneggiati.
- ▶ E1 significa che un sensore non sta funzionando correttamente, E2 : 2 sensori, E3 : 3 sensori, E4 : 4 sensori. Se il display lampeggia è stato individuato un difetto del sensore.
- ▶ Verificare che i sensori siano stati montati correttamente.
- ▶ In caso di urto, è possibile sostituire il sensore danneggiato con uno disponibile nella gamma parti sciolte Valeo.



- ▶ Si el zumbador produce un Beep, Beep, Beep sin ningún obstáculo, esto significa que uno o varios sensores han sido incorrectamente montados o dañados.
- ▶ E1 significa que un sensor no está funcionando adecuadamente, E2 : 2 sensores, E3 : 3 sensores, E4 : 4 sensores. La pantalla permite identificar el sensor defectuoso.
- ▶ Verificar el correcto montaje de los sensores.
- ▶ En caso de golpe, es posible sustituir el sensor afectado por otro disponible en la oferta de despiece Valeo.



- ▶ Se o som faz um barulho Beep Beep Beep sem obstáculos, isso significa que um ou vários sensores foram mal montados ou danificados.
- ▶ E1 significa que um sensor não está a funcionar bem. E2 : 2 sensores, E3 : 3 sensores, E4 : 4 sensores. Ecran flashing permite detectar sensor defeituoso.
- ▶ Verifique se os sensores estão bem montados.
- ▶ Em caso de acidente, pode substituir o sensor danificado por um disponível em Peças de Reparação Valeo.



- ▶ Wenn das Gerät ohne in der Nähe eines Hindernisses zu sein 3 Biep-Töne erzeugt, weist dies auf einen oder mehrere falsch angeschlossene oder defekte Sensoren hin.
- ▶ Die Anzeige "E1" bedeutet, dass ein Sensor nicht richtig arbeitet, "E2" = 2 Sensoren arbeiten nicht richtig etc... Anhand des blinkenden Bildschirms kann festgestellt werden, welcher Sensor defekt ist.
- ▶ Kontrollieren Sie bitte, ob die Sensoren richtig montiert und angeschlossen sind.
- ▶ Ein defekter Sensor kann durch einen Sensor aus dem Valeo Ersatzteile-Programm ersetzt werden.

Beep...Beep...Beep...

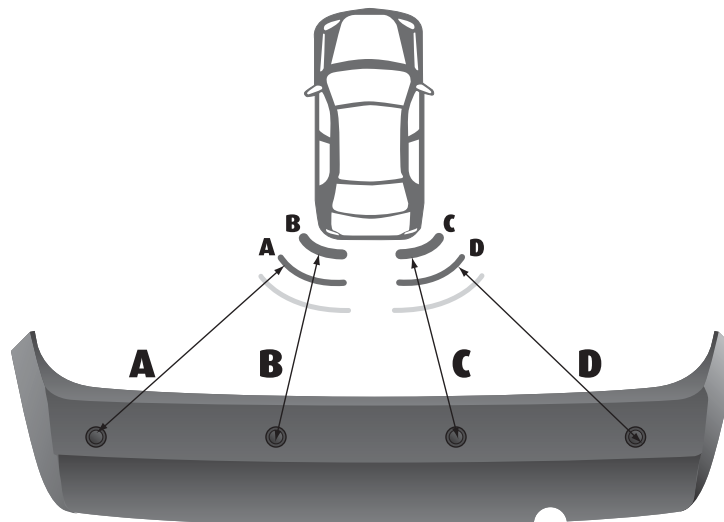

Valeo

VALEO SERVICE
 15, rue des Rosiers
 93582 Saint-Ouen Cedex
 France

