

Klappferrite für Rundkabel

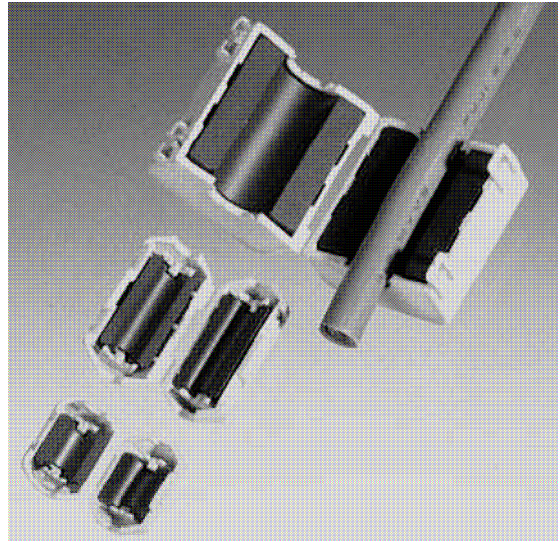

Bezeichnung	Abmessungen in mm			Impedance (Ω) 1 turn		Impedance (Ω) 2 turn		Max. Cable Diameter	Best.-Nr.
	A	B	C	25MHz	100MHz	25MHz	100MHz		
SFC-3	13,4	18,9	13,2	45	80	163	301	$\varnothing 3$	68-293-08
SFC-4	16,3	29,5	15	96	138	401	522	$\varnothing 4$ to $\varnothing 5$	68-293-09
SFC-5	21	32	17,5	177	242	660	766	$\varnothing 5$ to $\varnothing 6$	68-293-10
SFC-6	23,5	32	20	139	207	614	629	$\varnothing 6$ to $\varnothing 7$	68-293-11
SFC-10	32,6	32	29	149	266	640	733	$\varnothing 9,5$ to $\varnothing 10,5$	68-293-14

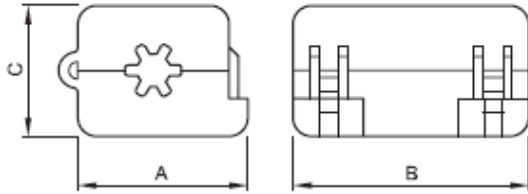